

Customer:	Order Reference:
Address:	Delivery / shipping address:
Postcode:	Postcode:
Contact Name:	Delivery Contact:
E-mail:	Delivery Telephone:
Telephone:	Date:

**** Default selections are underlined>****

Single colour <input type="checkbox"/> Dual-Colour <input type="checkbox"/> ⇒	Outside: Inside:	<u>Matt</u> <input type="checkbox"/> Satin <input type="checkbox"/> Gloss <input type="checkbox"/> Marine/ Swimming pool spec. Yes <input type="checkbox"/> <u>No</u> <input type="checkbox"/>
Drainage: <u>Visible</u> (with Black Caps) <input type="checkbox"/> Concealed <input type="checkbox"/> None <input type="checkbox"/>	Handle colour (standard offset locking handle): <u>White</u> <input type="checkbox"/> <u>Black</u> <input type="checkbox"/> Chrome <input type="checkbox"/> Satin Silver <input type="checkbox"/>	Locking: <u>Multi-point</u> <input type="checkbox"/> without <input type="checkbox"/>
Glazing beads (Square): <u>Mixed Int./Ext.</u> glazed (sash = Int. / Fixed = Ext.) <input type="checkbox"/> <u>Internally glazed throughout</u> (fixed field adapters)* <input type="checkbox"/>	Hinge protectors: Yes* <input type="checkbox"/> <u>No</u> <input type="checkbox"/>	Part Q: Yes* <input type="checkbox"/> <u>No</u> <input type="checkbox"/> (*Selection & window design may alter to comply)
Trickle ventilators: <u>No</u> <input type="checkbox"/> Yes <input type="checkbox"/> ⇒	Glazed-in ventilator (4103mm ² /m 45mm glass deduction vent per field) Black <input type="checkbox"/> White <input type="checkbox"/> RAL <input type="checkbox"/> Slot vent: Black <input type="checkbox"/> White <input type="checkbox"/> 2500mm ² (<700mm) <input type="checkbox"/> 5000mm ² (>700mm) <input type="checkbox"/> Head sash profile (>500mm) <input type="checkbox"/> within 42mm Add-on to head <input type="checkbox"/>	

Glass: <u>Unglazed</u> <input type="checkbox"/> Glazed <input type="checkbox"/> ⇒	2x4mm Low E Argon thermal spacer black (U= 1.2) <input type="checkbox"/> + TSG <input type="checkbox"/> 2x6mm Low E Argon thermal spacer black (U= 1.2) <input type="checkbox"/> + TSG <input type="checkbox"/>
Prepared for: 24mm <input type="checkbox"/> <u>28mm</u> <input type="checkbox"/> 36mm <input type="checkbox"/>	*6.4+4mm Low E Argon thermal spacer black (U= 1.2) <input type="checkbox"/> + TSG (float LSG) <input type="checkbox"/> *6.4+6mm Low E Argon thermal spacer black (U= 1.2) <input type="checkbox"/> + TSG (float LSG) <input type="checkbox"/>

Design & Section details:

1. Typical head, 2. Typical jamb (side hung handle side), 3. Bottom with cill options, 4. Typical mullion/transom (Mixed Int./Ext. glazed), 5. Typical mullion/transom (Int. glazed), 6. Slot-vent to head sash profile, 7. Slot-vent head within 42mm add-on to head & 8. Glazed-In trickle vent typical.

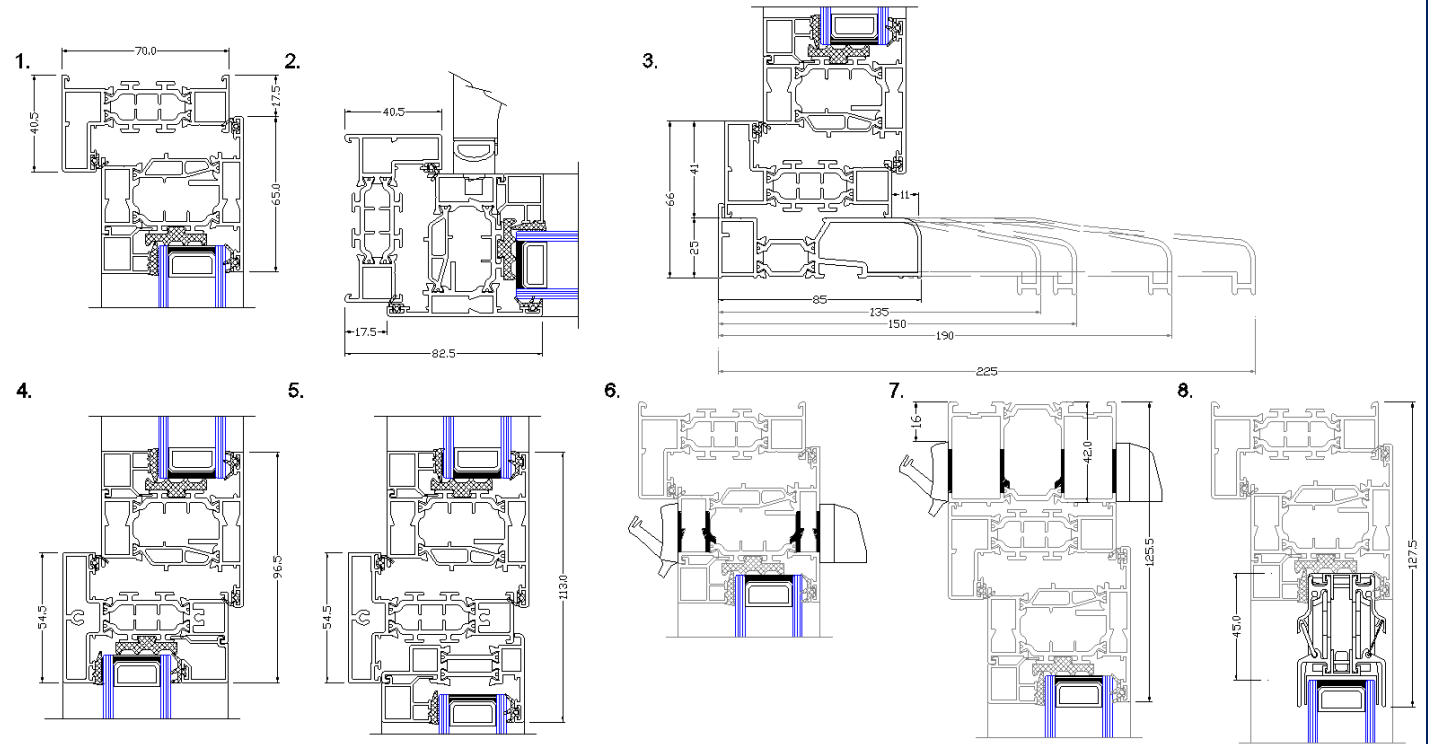

Side hung sash: Width [Min./Max.]: 400mm/800mm Height [Min./Max.]: 400mm/1400mm (Std: 12"/22kg 16"/28kg open 60° Egress: Max.40kg open 90°) Maximum Weight: 40kg	Top hung sash: Width [Min./Max.]: 400mm/1400mm Height [Min./Max.]: 400mm/1300mm (24"/40kg open 32° 16"/21kg open 80° 10"/16kg open 50°) Maximum Weight: 40kg	Fixed lights: Width & Height [Min./Max.]: 400mm/2100mm [Perimeter Max.: 4800mm] Multi-light window designs will be subject to transom/mullion (lxx/lyy) limitations!
---	---	--

RESIDENTIAL PLUS - SC

ORDER FORM QUOTATION

Please e-mail to: pricing@cotswoldtradealuminium.co.uk



NOTE: Hinge types: STD = Standard side/ top hung opening, EGR = Egress (customer to ensure min. opening achieved), RES = Restrictor (nominal 100mm)

Ref	Style (Viewed Outside) <small>(Please show division/ mullion/ transom dimensions, T/vents & point to hinge)</small>	Qty	Size (mm) <small>(Overall inc. all add-ons & cills)</small>	Cill <small>(Please select)</small>	Add-ons <small>(Please select - 20 or 42mm)</small>	Hinge <small>(Please select)</small>	Glass <small>(Clear / Satin TSG / Bars)</small>	Special / Notes
			Width	None	T	STD		
				85	135	B	EGR	
			Height	150	190	L	RES	
				225		R		
			Width	None	T	STD		
				85	135	B	EGR	
			Height	150	190	L	RES	
				225		R		
			Width	None	T	STD		
				85	135	B	EGR	
			Height	150	190	L	RES	
				225		R		
			Width	None	T	STD		
				85	135	B	EGR	
			Height	150	190	L	RES	
				225		R		
			Width	None	T	STD		
				85	135	B	EGR	
			Height	150	190	L	RES	
				225		R		
			Width	None	T	STD		
				85	135	B	EGR	
			Height	150	190	L	RES	
				225		R		
			Width	None	T	STD		
				85	135	B	EGR	
			Height	150	190	L	RES	
				225		R		
			Width	None	T	STD		
				85	135	B	EGR	
			Height	150	190	L	RES	
				225		R		
			Width	None	T	STD		
				85	135	B	EGR	
			Height	150	190	L	RES	
				225		R		